

- Legend**
- Occidental Chemical
  - Air Products
  - DeBruce Grain
  - Abbott Labs
  - Atofina Chemical
  - Builders Inc
  - KGE
  - City of Wichita
  - Chris Truck Lines
  - US Road Freight Express
  - Transfer Station
  - Mid-Continent Industrial
  - Bombardier Lear Jet
  - Sharpline Converting
  - CNH Wichita
  - Cessna
  - Wolfe Electric
  - Railroad

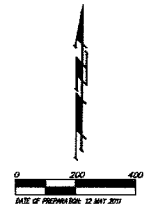

It is understood that the Sedgwick County GIS, Division of Information and Operations, may not indicate or warrant to follow that there are no restrictions in information displayed in the data map.  
 The GIS personnel make no warranty or representation, either expressed or implied, with respect to the information or the data displayed.



Subbasin ID	Area (acres)	TR-55				Flows	
		Sheet Flow	Shallow Concentrated Flow	Channel Flow	Total Tc (min)	Q <sub>s</sub> (cfs)	Q <sub>w</sub> (cfs)
A	61	L = 302 S = 0.2%	L = 307 S = 0.2%	L = 202 S = 4.2%	140.3	37	63
B	101	L = 202 S = 0.2%	L = 300 S = 0.2%	L = 1002 S = 0.2%	110.0	60	229
C	126	L = 202 S = 0.1%	L = 1420 S = 0.1%	L = 1002 S = 0.1%	100.6	118	312
D	89	L = 202 S = 0.1%	L = 1552 S = 0.1%	---	---	50.1	43
E	30	L = 202 S = 0.5%	L = 202 S = 0.5%	L = 4002 S = 0.1%	87.6	37	68

**LEGEND**

- Basin ID
- Basin Boundary (color varies)
- Basin Reach (for Tc calcs)

**EXISTING DRY DEPRESSION (Bottom = 1306.3)**

STAGE	INFLOW	OUTFLOW*	ELEVATION
2'F	364 cfs	100 cfs	1308.2
10'F	500 cfs	220 cfs	1308.5
100'F	798 cfs	468 cfs	1308.9

**PROPOSED POND**

ELEVATION	AREA (sq ft)
1306	0
1307	71000
1308	2087460
1309	3145160

\* Outflow is quantity of runoff which occurs from the area of the City and that which flows over the 55th Street roadway.

There is no FEMA 500-A on this property or at this date per FEMA 500-A Panel 465 of 710 for Sedgewick County, Kansas, effective February 3, 2007.

**EXISTING CONDITIONS  
G&D LANDFILL**

Baughman Company, P.A.  
INCORPORATED IN THE STATE OF PENNSYLVANIA  
 1000 EAST 12TH AVENUE, SUITE 200, DENVER, COLORADO 80202

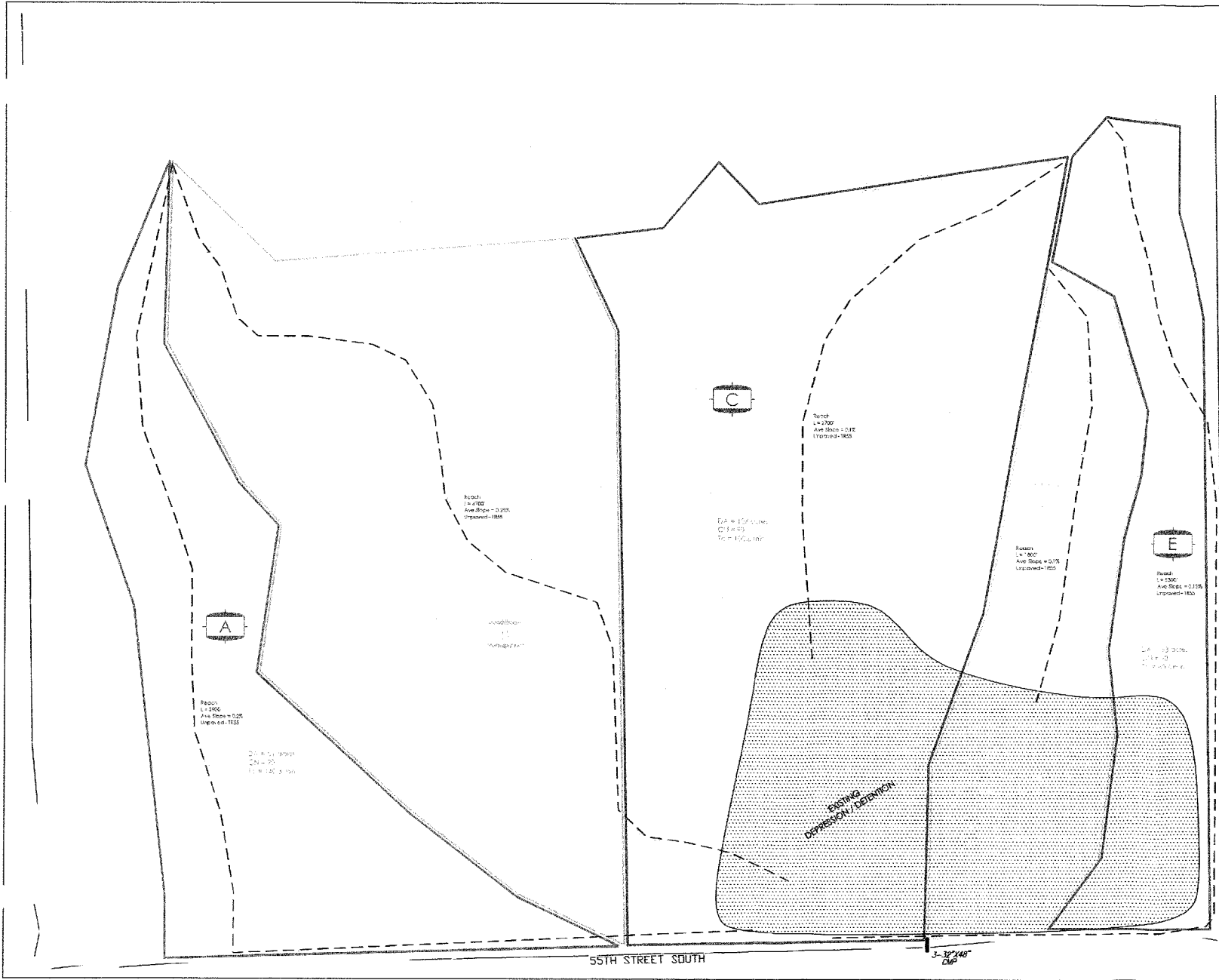

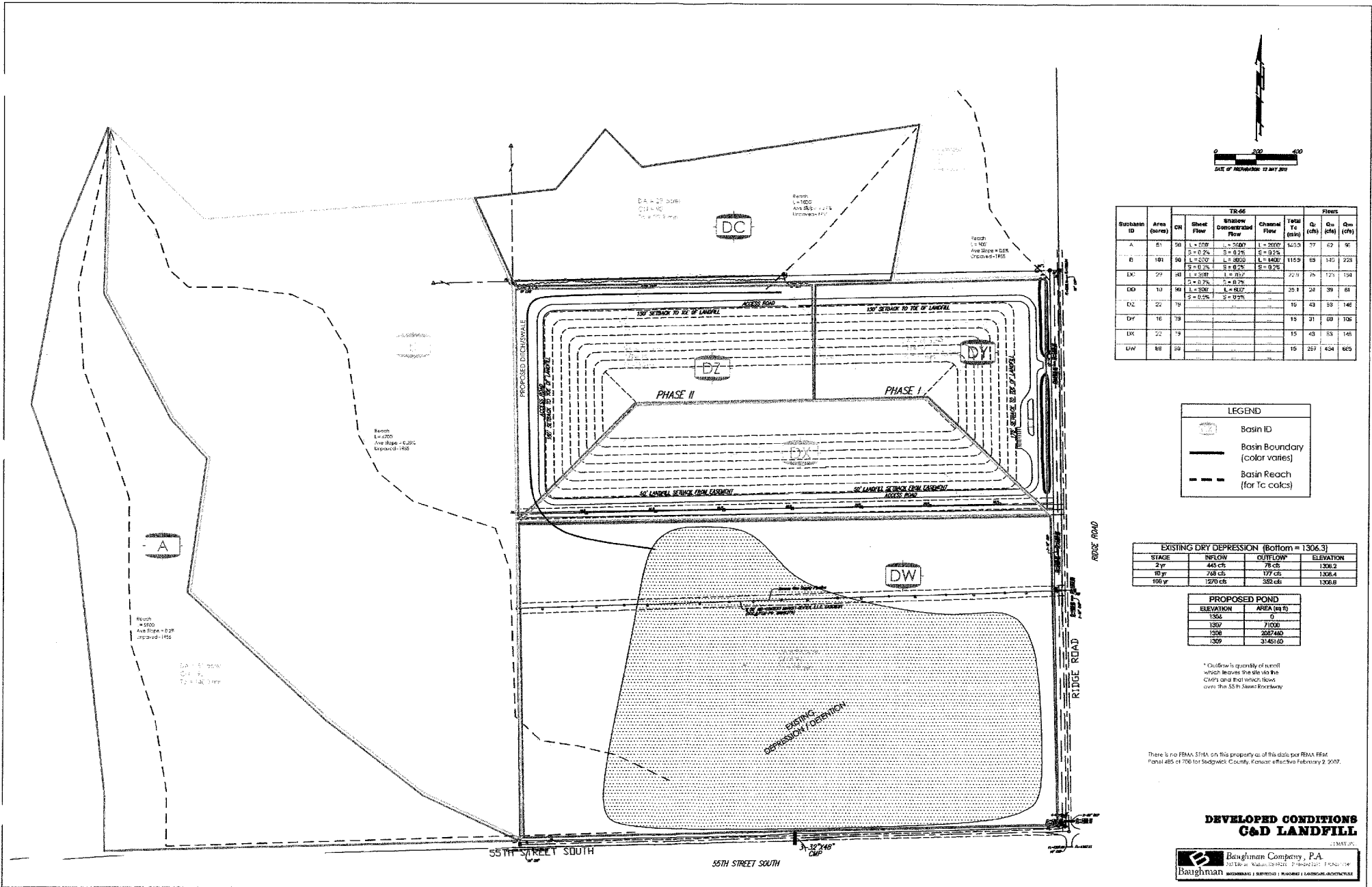

Subbasin ID	Area (acres)	CN	TR-55		Final Tc (hrs)	Flows		
			Sheet Flow	Channel Flow		Qp (cfs)	Qm (cfs)	
A	81.50	50	L = 2700 S = 0.2%	L = 2000 S = 0.2%	1410.0	57	62	96
B	101.50	50	L = 5000 S = 0.2%	L = 4400 S = 0.2%	1155.0	63	140	223
DC	29.46	50	L = 500 S = 0.2%	L = 100 S = 0.2%	22.9	75	125	194
DZ	10.56	50	L = 500 S = 0.2%	L = 100 S = 0.2%	25.1	24	39	61
DY	16.78	50			15	31	60	106
DW	22.19	50			15	43	53	145
UW	88.50	50			15	207	454	605

LEGEND	
	Basin ID
	Basin Boundary (color varies)
	Basin Reach (for Tc calcs)

EXISTING DRY DEPRESSION (Bottom = 1306.3)		
STAGE	INFLOW	OUTFLOW
2 yr	445 cfs	78 cfs
10 yr	748 cfs	177 cfs
100 yr	1270 cfs	382 cfs

PROPOSED POND	
ELEVATION	AREA (sq ft)
1304	0
1309	7100
1306	208740
1309	314510

\* Outflow is quantity of runoff which leaves the site via the CHS and that which flows over the 55th Street Rightway.

There is no FEMA FEMA on this property as of this date per FEMA Panel 485 of 706 for Sedgewick County, Kansas effective February 2, 2007.

**DEVELOPED CONDITIONS G&D LANDFILL**

**B** Baughman Company, P.A.  
10138 W. Hudson Street, Overland Park, KS 66207  
Baughman ENGINEERING | SURVEYING | PLANNING | LANDSCAPE ARCHITECTURE

