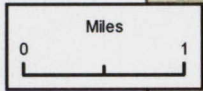
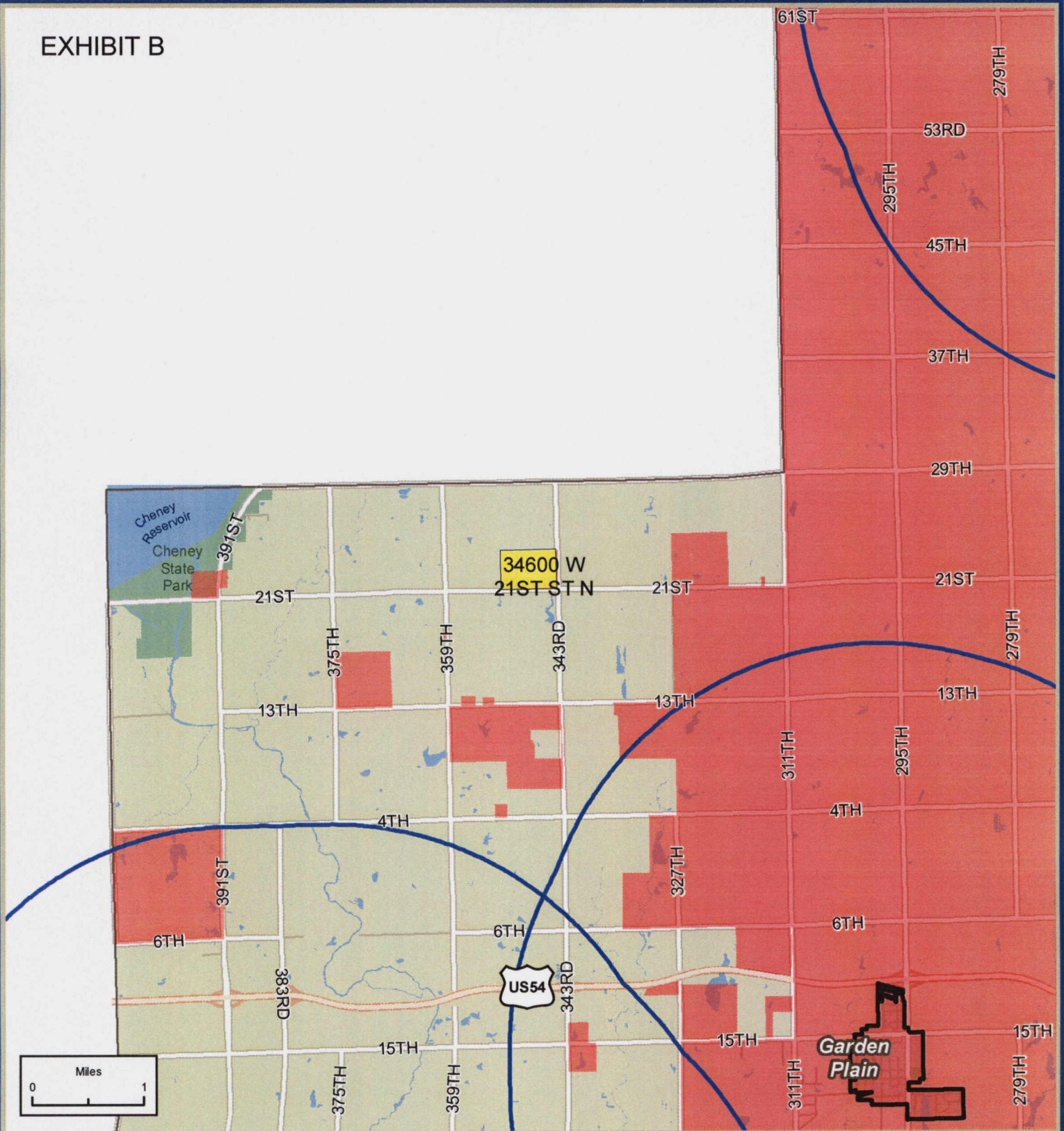

EXHIBIT B



Geographic Information Services
Division of Information & Operations
www.sedgwickcounty.org/gis

Date: 4/11/2013

© 2013 Sedgwick County Kansas Government. All rights reserved.

FILE: C:\gis\GisMaps\Fire\Petitions\34600_W_21st_St_N.mxd
NAME: smeneffee



**Fire Petition #13-1
34600 W 21st St N**

Sedgwick County, Kansas

Legend

-  Petitioned Parcel
-  3 Mile City Buffers
-  Sedgwick County Fire District
-  City Limits

It is understood that the Sedgwick County GIS, Division of Information and Operations, has no indication or reason to believe that there are inaccuracies in information incorporated in the base map.

The GIS personnel make no warranty or representation, either expressed or implied, with respect to the information or the data displayed.