



K A N S A S

DEPARTMENT OF HEALTH AND ENVIRONMENT

PERMIT APPLICATION FOR A WASTE TIRE PROCESSING FACILITY

This form is to be used by persons engaged in processing tires at a fixed site.

A. APPLICANT INFORMATION:

Company Name: Big State Tire & Axle, Inc.

Street Address: 5929 N Broadway Park City, Kansas 67219
(City) (State) (Zip)

Mailing Address: 5929 N Broadway Park City, Kansas 67219
(City) (State) (Zip)

Contact Person: Melissa Endsley Title: Director of Operations

Telephone Number: (316) 744-3853 Fax Number: (316) 744-3737 E-Mail: rogue.transport.lc@yahoo.com

B. SITE INFORMATION

Landowner Name: Roy Ebarb

Mailing Address: 5929 N Broadway Park City, Kansas 67219
(City) (State) (Zip)

Site Address: 5929 N Broadway Park City, Kansas 67219
(City) (State) (Zip)

Phone: (316) 744-3853

C. County _____, 1/4 Section _____, Section _____, Township X, Range _____

Driving Directions From Nearest City

I-35 to the 61st North exit then go west to Broadway. At Broadway
turn South (left) and drive two blocks to 59th & Broadway. On west side
of street.

D. Size of Site: 5 acres (acres)

- E. Number of tires currently on site: 10,000
- F. Estimated number of waste tires to be received daily: 100 2-3 times per week
- G. Estimated number of waste tires to be stored: 2,000
- H. Time period that waste tires will be stored: 4-6 months
- I. Intended purpose of tires stored at this site: they will be remanufactured for mobile homes and also sold to pony pal for tire swings.
- J. Storage method: Banded and stacked. They are either stored in or on trailers or lined in a fence row on the property.
(Box van trailers and flatbed trailers)
- K. Processing Equipment - List all processing equipment to be used on the site and describe how it processes the tires.

| Equipment (Brand, Model, Etc.) | Process (Bale, Quarter, Bagel, Shred, Etc.) |
|--|--|
| <u>Tire banded/baler</u> | <u>Bands tires together</u> |
| <u>New Holland skid loader</u> | <u>Moves tires</u> |
| <u>New Holland Fork Lift</u> | <u>Stacks tires</u> |
| <u>Lufkin flatbed/steepdeck trailer with tie cages - Freightliner Trucks</u> | <u>Hauls tires to recycler</u> <u>Hauls tires to recycler</u> |

Other Attachments: (See instructions.)

- L. Application fee of \$250.
- M. Land use and zoning certification.
- N. Land use description with in one-half mile radius
- O. Maps
- P. Site Operation Plan
- Q. Contingency Plan
- R. Closure Plan
- S. Financial Assurance
- T. Disclosure Statement

I certify that all the information provided in this permit application is true and correct to the best of my knowledge. I will abide by the rules of the Kansas Department of Health and Environment.

Signature: Melissa Endsley Date: 02/21/12
 Print Name: Melissa Endsley Title: Director of Operations

Note: The signature must be notarized.

April 17, 2003

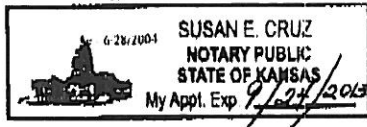

State of Kansas
 County of Sedgwick
 Signed before me 2-21-12
 Susan E. Cruz

WASTE TIRE PROCESSING FACILITY CERTIFICATION

Applicant's Name Big State Tire & AHE, Inc

As specified in K.S.A. 65-3407 Permits to construct, alter or operate solid waste processing facilities and solid waste disposal areas, the secretary shall require the following information as part of this application:

Solid Waste Management Plan Consistency

- (1) Certification by the board of county commissioners or the mayor of a designated city responsible for the development and adoption of the solid waste management plan for the location where the processing facility or disposal area is or will be located that the processing facility or disposal area is consistent with the plan. This certification shall not apply to a solid waste disposal area for disposal of only solid waste produced on site from manufacturing and industrial processes or from on-site construction or demolition activities.

- The Facility Or Disposal Area Is Consistent With Solid Waste Management Plan
 The Facility Or Disposal Area Is Not Consistent With Solid Waste Management Plan

Name (Print or Type) _____ Signature _____
Title _____ Date _____
County or City _____ Street Address _____ City, Zip Code _____

Zoning or Land Use Consistency

- (2) If the location is zoned, certification by the local planning and zoning authority that the processing facility or disposal area is consistent with local land use restrictions or, if the location is not zoned, certification from the board of county commissioners that the processing facility or disposal area is compatible with surrounding land use.

Zoned

- The Facility Or Disposal Area Is Consistent With Local Land Use Restrictions Or Zoning
 The Facility Or Disposal Area Is Not Consistent With Local Land Use Restrictions Or Zoning

Not Zoned

- The Facility Or Disposal Area Is Compatible With Surrounding Land Use
 The Facility Or Disposal Area Is Not Compatible With Surrounding Land Use

Jack Whitson, _____ Signature Jack Whitson
Name (Print or Type) _____
Zoning Administrator Title _____ Date 2-2-2012
City of Park City, 6110 N Hydraulic, Park City, KS 67219
Agency or County _____ Street Address _____ City, Zip Code _____

If a special use permit is required, please attach a copy to this application.

The facility is compatible with the surrounding land use, but the disposal of waste tires is not compatible.

NTS

W
Commercial

Residential

Solid Metal Fence

Empty Land

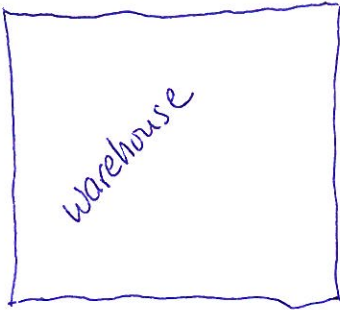

we can not use gets recycled
the are able to be welded together
to make useable axles and what
Scrap axles



Rows of Axles useable
Tire Fence useable

Rows of Axles useable
Tire Fence useable

Solid Metal Fence
Banded Tires useable



Box Trailer
Tires useable

vehicle parking



Office



Flat bed
loaded
with tires
for recycling

Commercial Truck
parking

Tire fence useable

Driveway

59th St N.

Driveway



Box Trailers
NO Tires

Commercial Truck
parking



Box Trailer
Tires useable

Banded tires waiting
to be recycled.

Broadway

Driveway

Commercial

E

NTS

Commercial

N

S









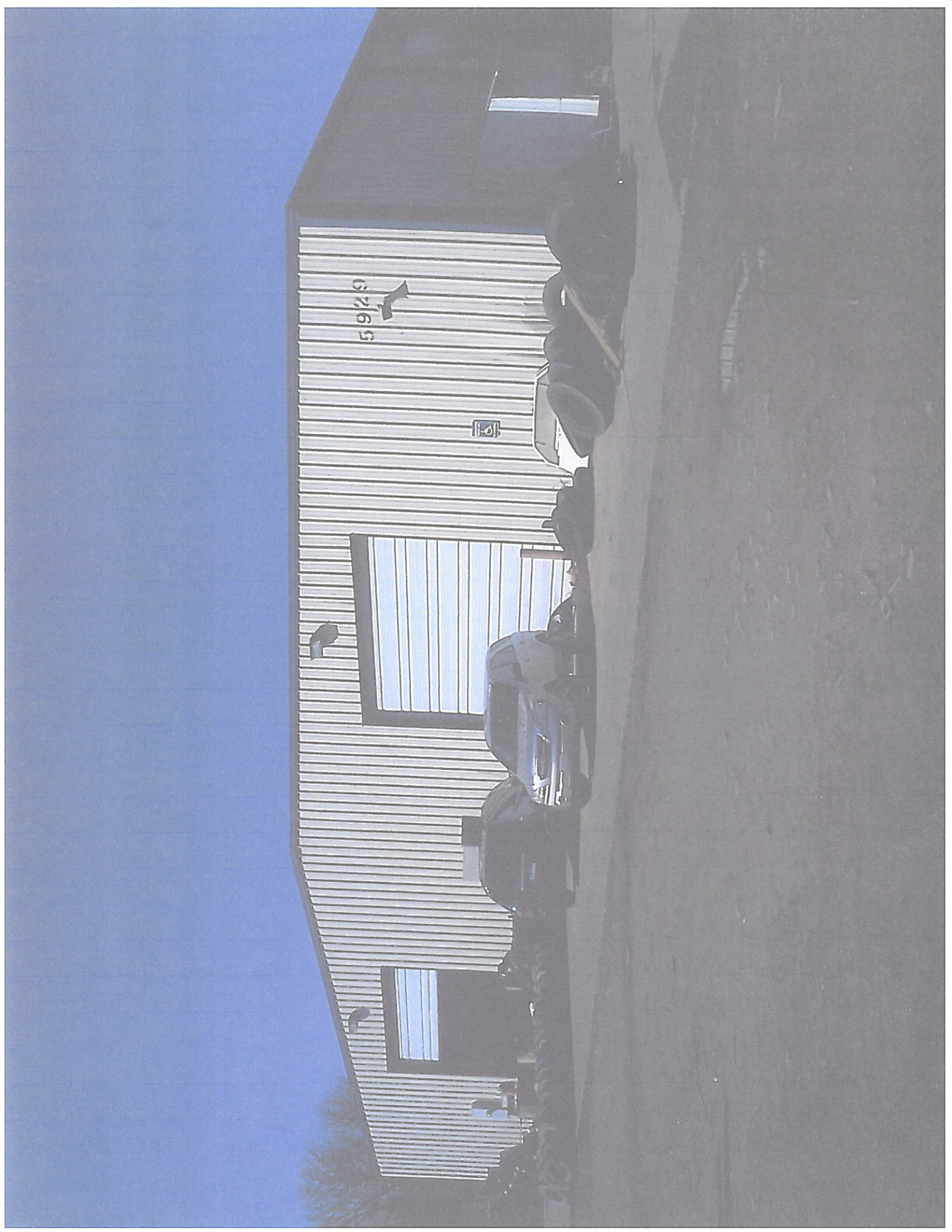

59265



Printed: 3/14/2012 11:15:11 AM
 Powered By GeoSmart

| | |
|--|-------------------------|
| | City Limit |
| | Boundaries |
| | CELLTOWER_PEMIT |
| | Historic Districts |
| | Old Town |
| | Delano Overlay District |
| | NO |
| | YES |
| | Property Parcels |
| | Lot Block |
| | Subdivisions |
| | Historic Sites |
| | REGIONAL |
| | STATE/NATION-AL |
| | STATE |
| | Zoning Cases |
| | RR |
| | SF-20 |
| | SF-10 |
| | SF-5 |
| | TF-3 |
| | MF-18 |
| | MF-29 |
| | B |
| | MH |
| | NO |
| | GO |
| | NR |
| | LC |
| | OW |
| | GC |
| | AFB |
| | IP-A |
| | IP |
| | CBD |
| | LI |
| | GI |
| | PUD |



Every reasonable effort has been made to assure the accuracy of the maps and associated data provided herein. This information is provided with the understanding that the data are susceptible to a degree of error, and conditions drawn from such information are the responsibility of the reader. The City of Wichita makes no warranty, representation or guaranty as to the content, accuracy, timeliness or completeness of any of the data provided herein. Some data provided here and used for the preparation of these maps has been obtained from public records not created or maintained by the City of Wichita. The City of Wichita shall assume no liability for any decisions made or actions taken or not taken by the reader in reliance upon any information or data furnished hereunder. The user should consult with the appropriate departmental staff member, e.g. Planning, Parks & Recreation, etc. to confirm the accuracy of information appearing in the visual presentations accessible through these web pages.





- City Limit
- Boundaries
- Property Parcels
- Base Flood Elevations
- Cross Sections
- Flood Way
- Flood Zones
- 0.2 PCT ANNUAL CHANGE FLOOD HAZARD
- X PROTECTED BY LEVEE
- AH;AE;A;AO FIRM PANELS
- City Limits
- Small Cities
- Sedgwick County
- Wichita

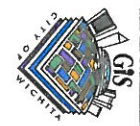

Every reasonable effort has been made to assure the accuracy of the maps and associated data provided herein. This information is provided with the understanding that the data are susceptible to a degree of error, and conditions shown on such information are the responsibility of the reader. The City of Wichita makes no warranty, representation or guaranty as to the content, accuracy, timeliness or completeness of any of the data provided herein. Some data provided here and used for the preparation of these maps has been obtained from public records not created or maintained by the City of Wichita. The City of Wichita shall assume no liability for any decisions made or actions taken or not taken by the reader in reliance upon any information or data furnished hereunder. The user should consult with the appropriate departmental staff member, e.g. Planning, Parks & Recreation, etc. to confirm the accuracy of information appearing in the visual presentations accessible through these web pages.



